

EX-ROLL



1 Open the back panel to unfold the telescopic pole.



2 Lift the pole into a vertical position and slide it towards the centre of the base.



3 Close the panel, ensuring the pole is positioned correctly.



4 Open the front panel.



5 Pull the graphic up from the base.



6 Hang the top frame onto the hook.

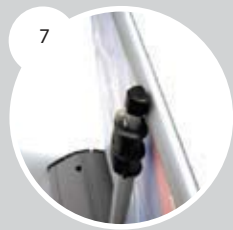

7 Open both clips and raise the pole to the desired height.

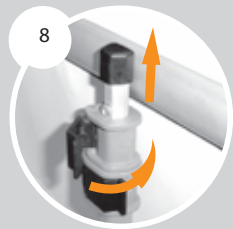

8 Close the clips to lock in place. Close the front panel on the base.



The ever popular roll-up banner has been innovatively re-engineered to create the dynamic Ex-Roll. The attached telescopic pole and unique fold-away system mean there are no loose parts!

Ex-Rolls are available double or single sided and the images are printed on non-curling material to present a consistently flat image. The images are easily interchangeable offering good value over time.

X-LARGE	▲ Var - 2.7m	▲ Var - 2.3m
	▶ 1.5m	▶ 1.2m
	▣ 8.4 kg	▣ 7.4 kg
MEDIUM	▲ Var - 2.2m	▲ Var - 2.1m
	▶ 1.0m	▶ 0.85m
	▣ 6.0 kg	▣ 5.0 kg



DOUBLE IMPACT DISPLAYS double impact displays

www.doubleimpact.com.au
P. (02) 9999 1322 F. (02) 9999 1955